

Williams Elementary

ALC

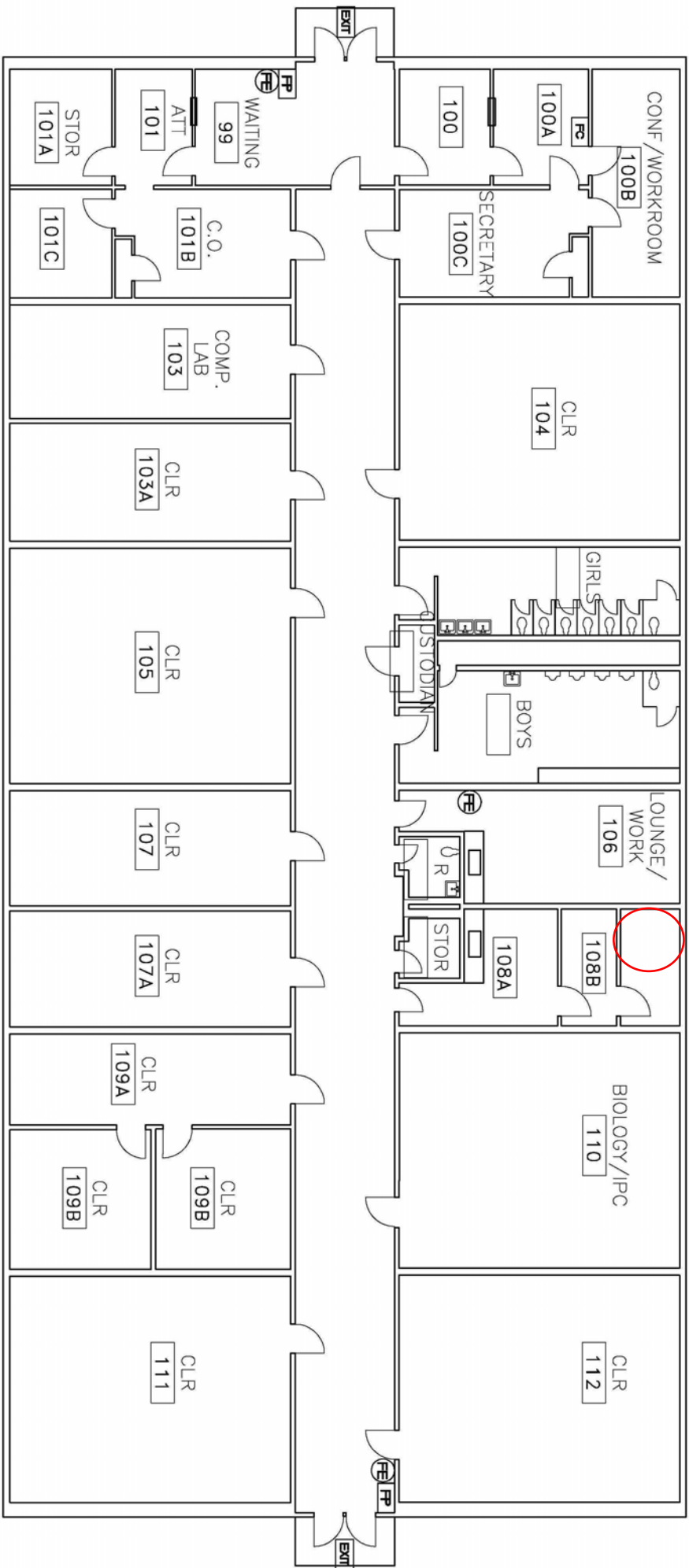

McNeil Elementary

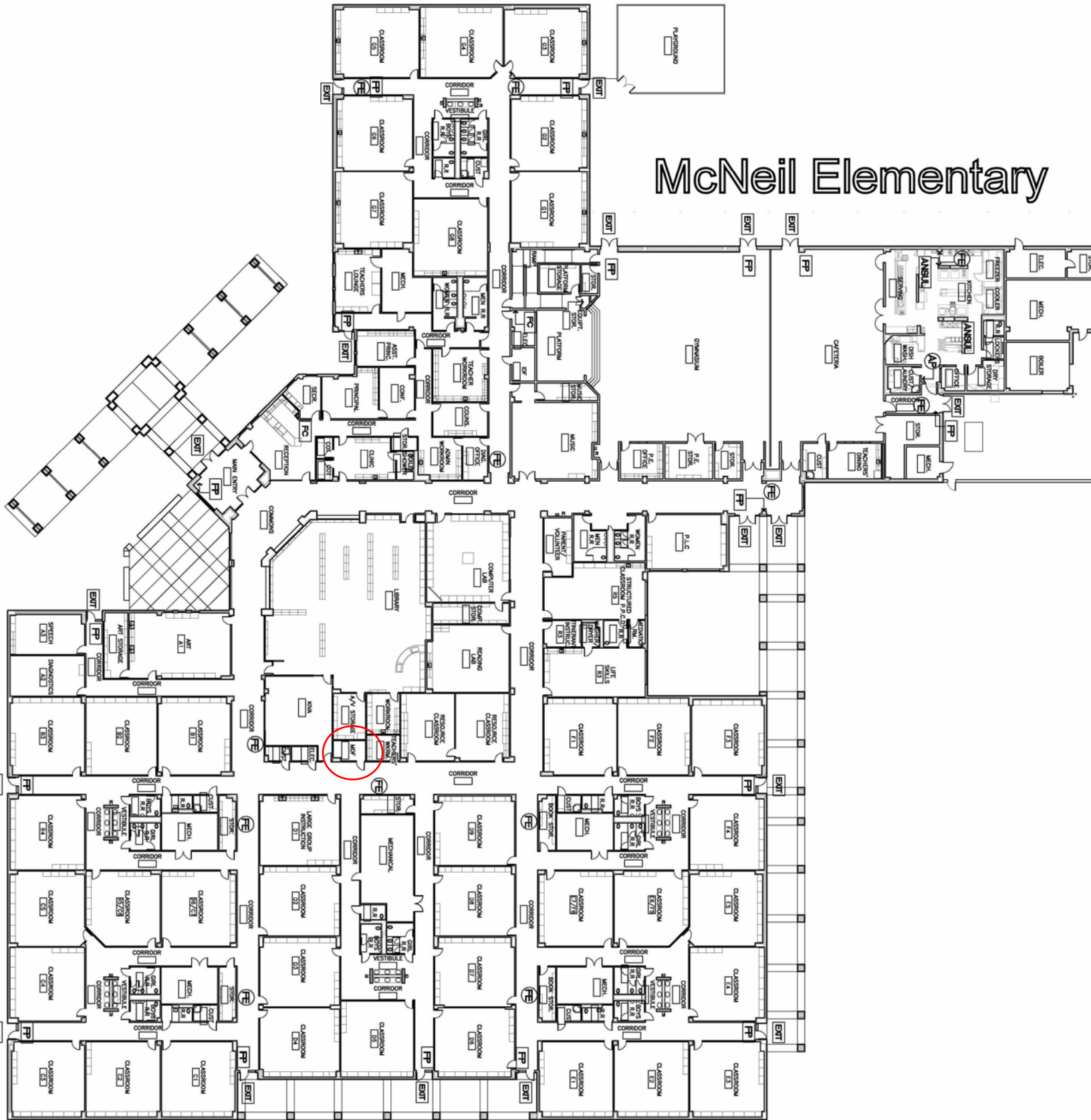

Pink

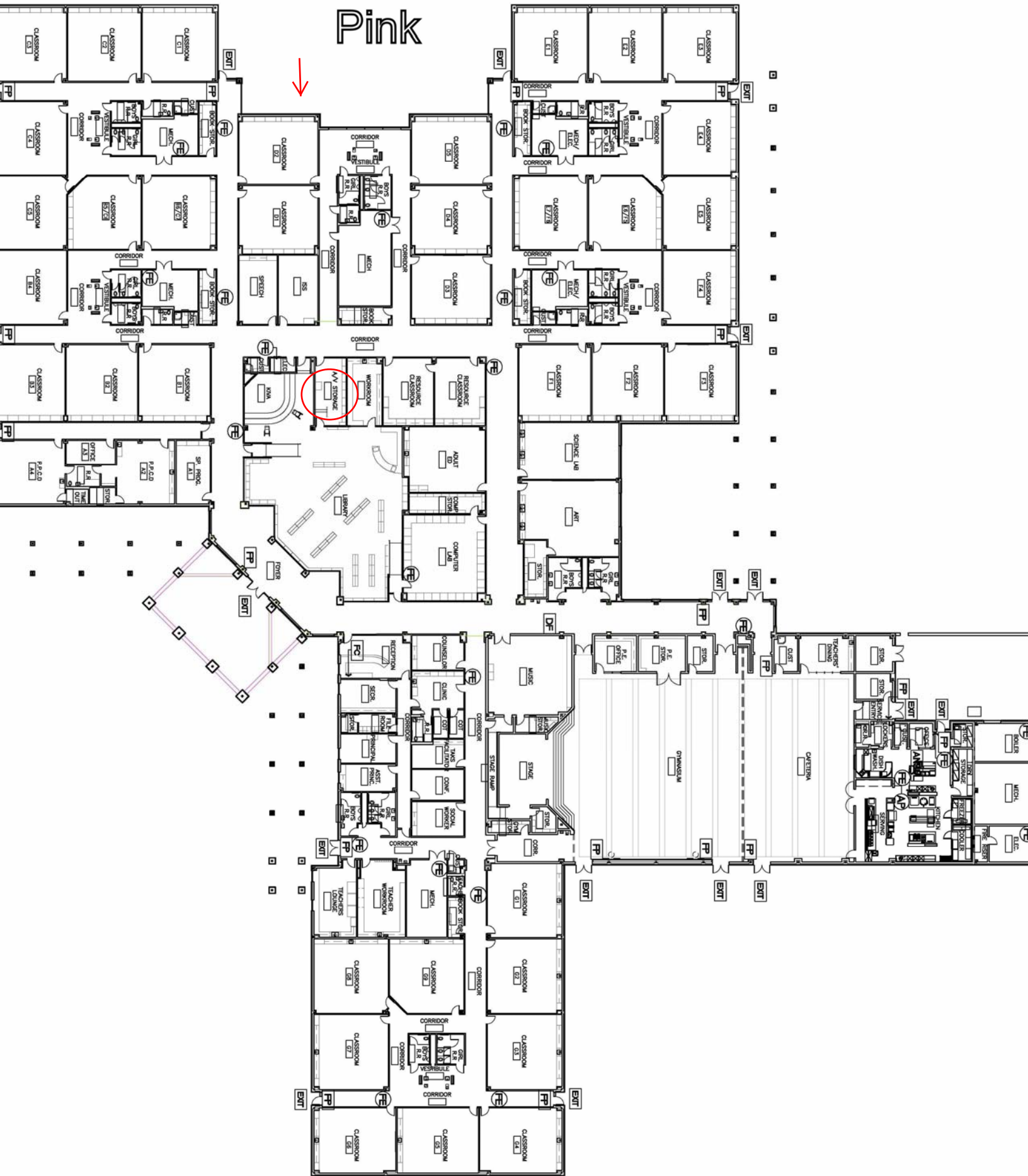

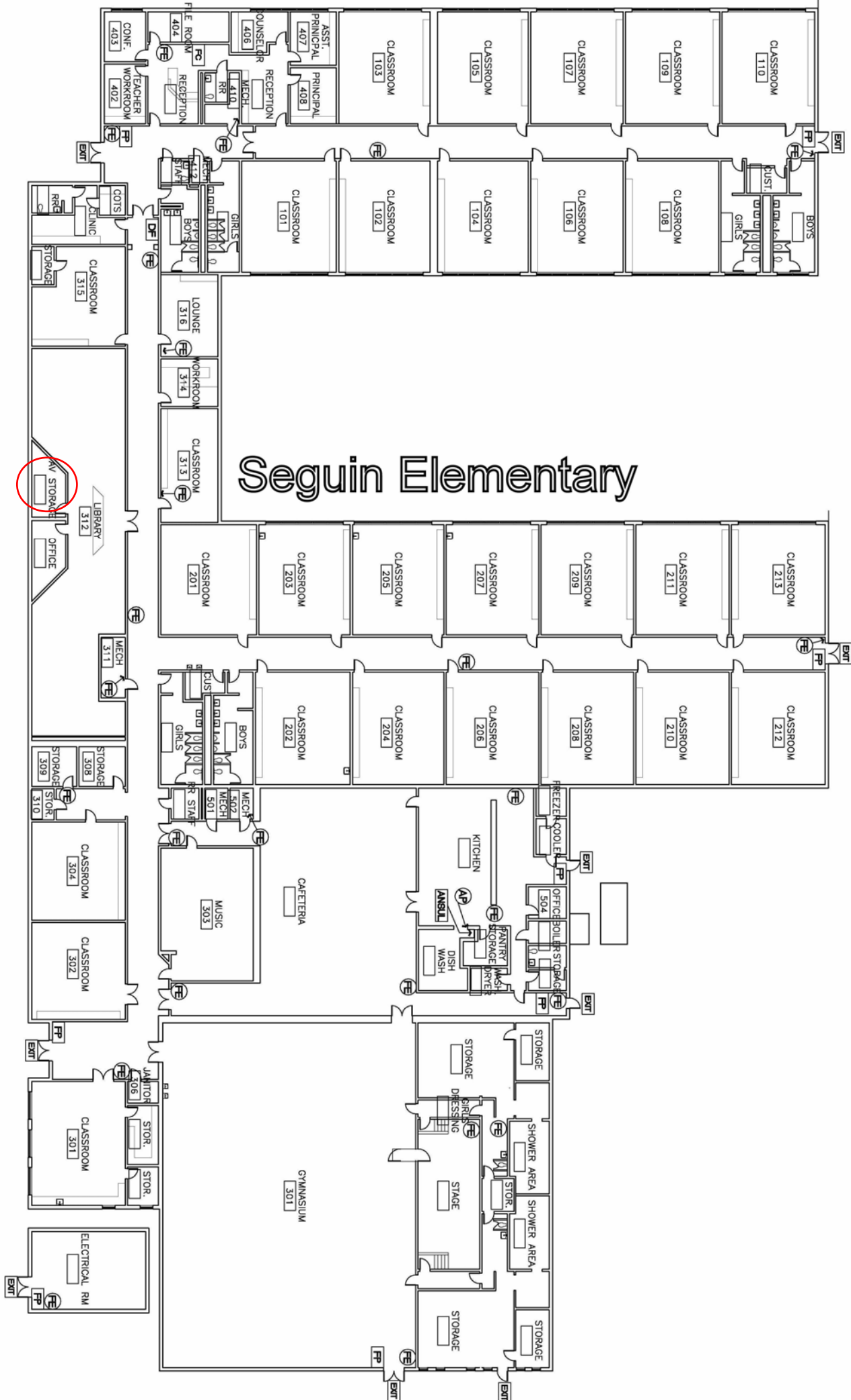

Seguin Elementary

Smith Elementary

The floor plan of Smith Elementary is divided into several main sections. At the top, there are several portable classrooms labeled PORTABLE 11 through 15. Below these are classrooms F1 through F4, a computer lab, and a library. The central part of the plan features a large grassy area. To the right of the grass is a long row of classrooms labeled D1 through D9, along with an art room (D1), music room (D6), and a gymnasium. The bottom section contains classrooms A1 through A4, B1 through B4, C1 through C4, and D1 through D4. Other rooms include a teacher lounge, principal's office, reception, kitchen, and various storage areas. A red circle highlights a classroom in the bottom left section, near the kitchen and reception area.

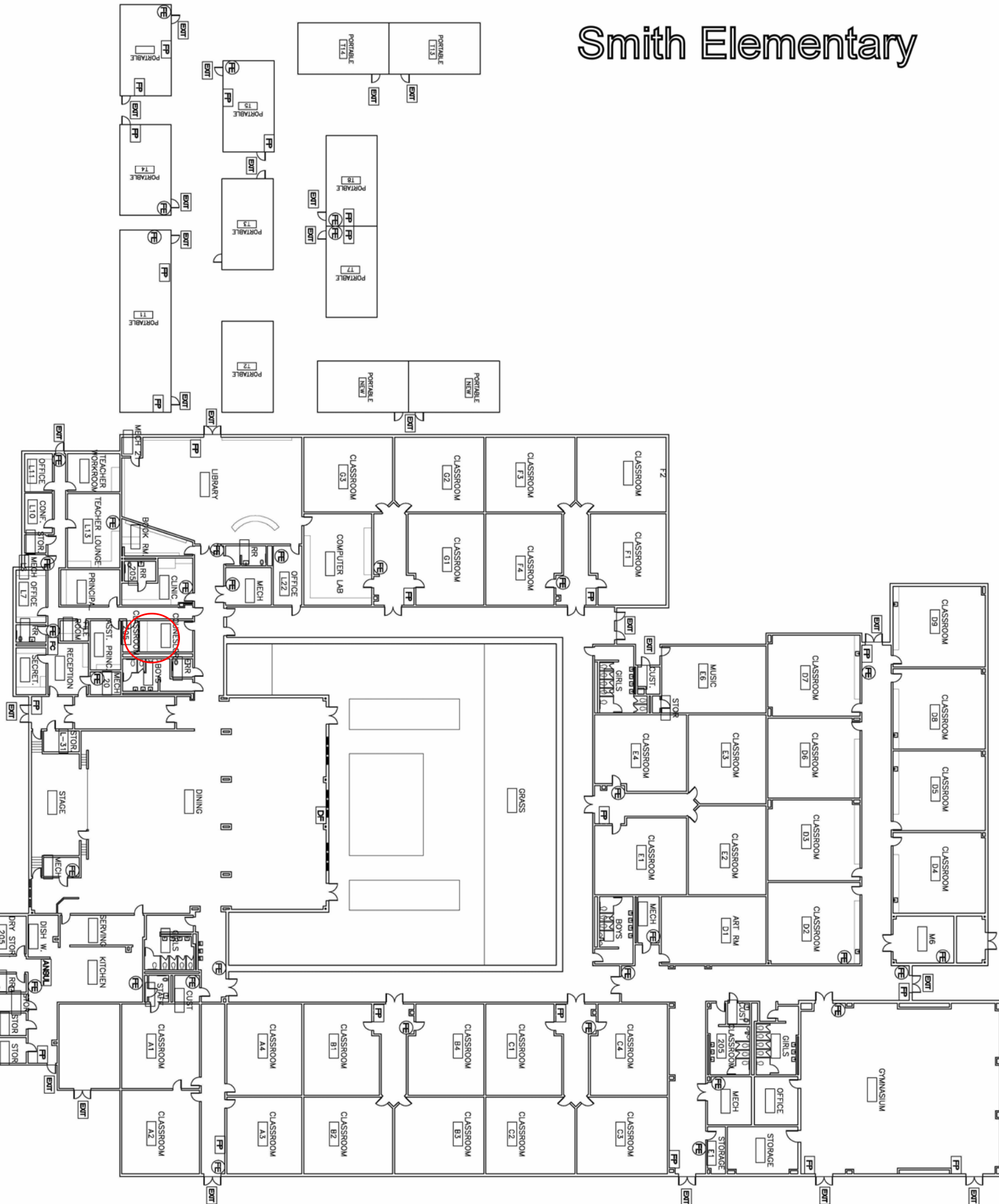

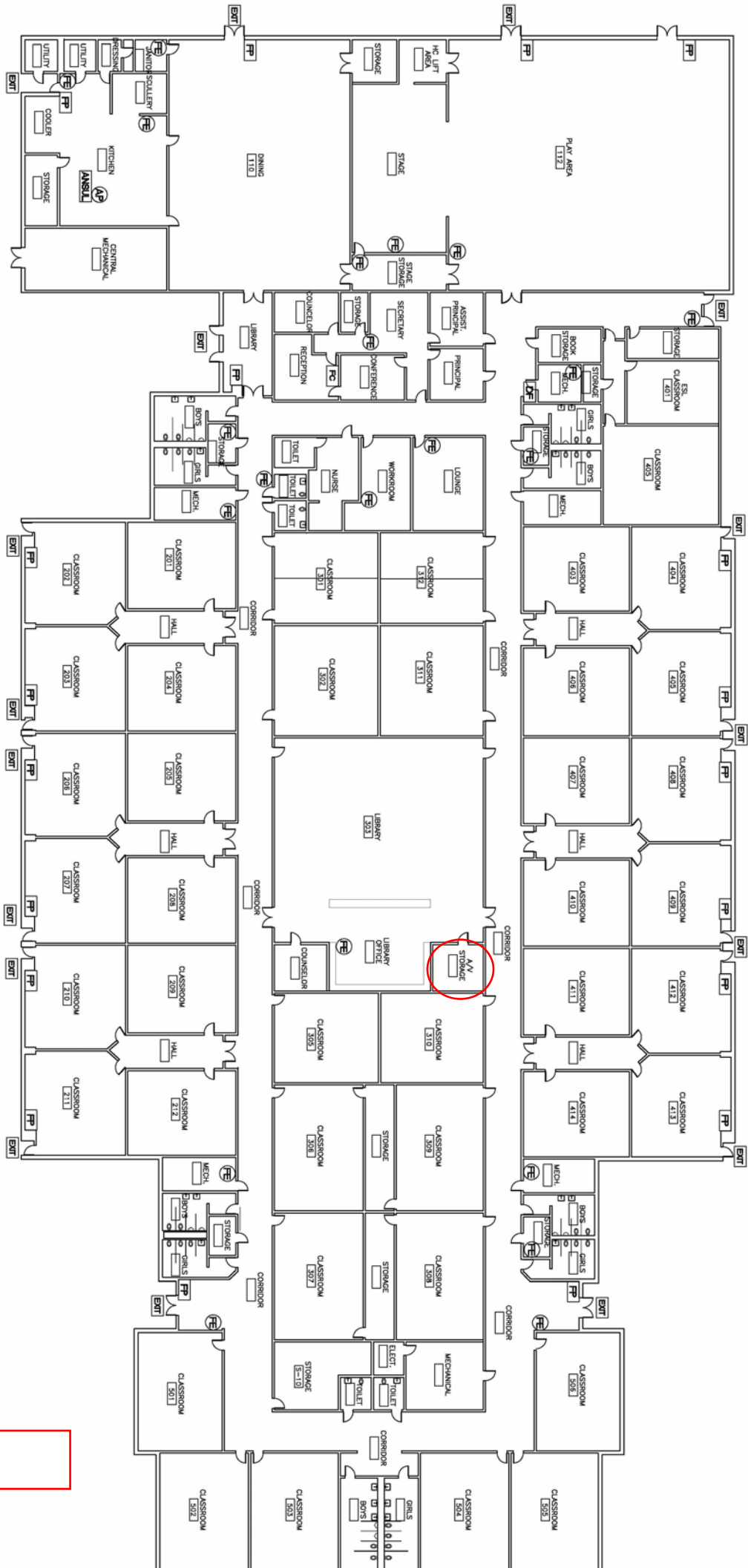

Taylor Ray
Elementary

This is a detailed architectural floor plan of a multi-story building, likely a school or institutional structure. The plan shows numerous rooms, corridors, and service areas. A red circle highlights a specific room in the central part of the building. The drawing is color-coded with yellow, pink, and blue lines and includes various symbols for doors, windows, and furniture.

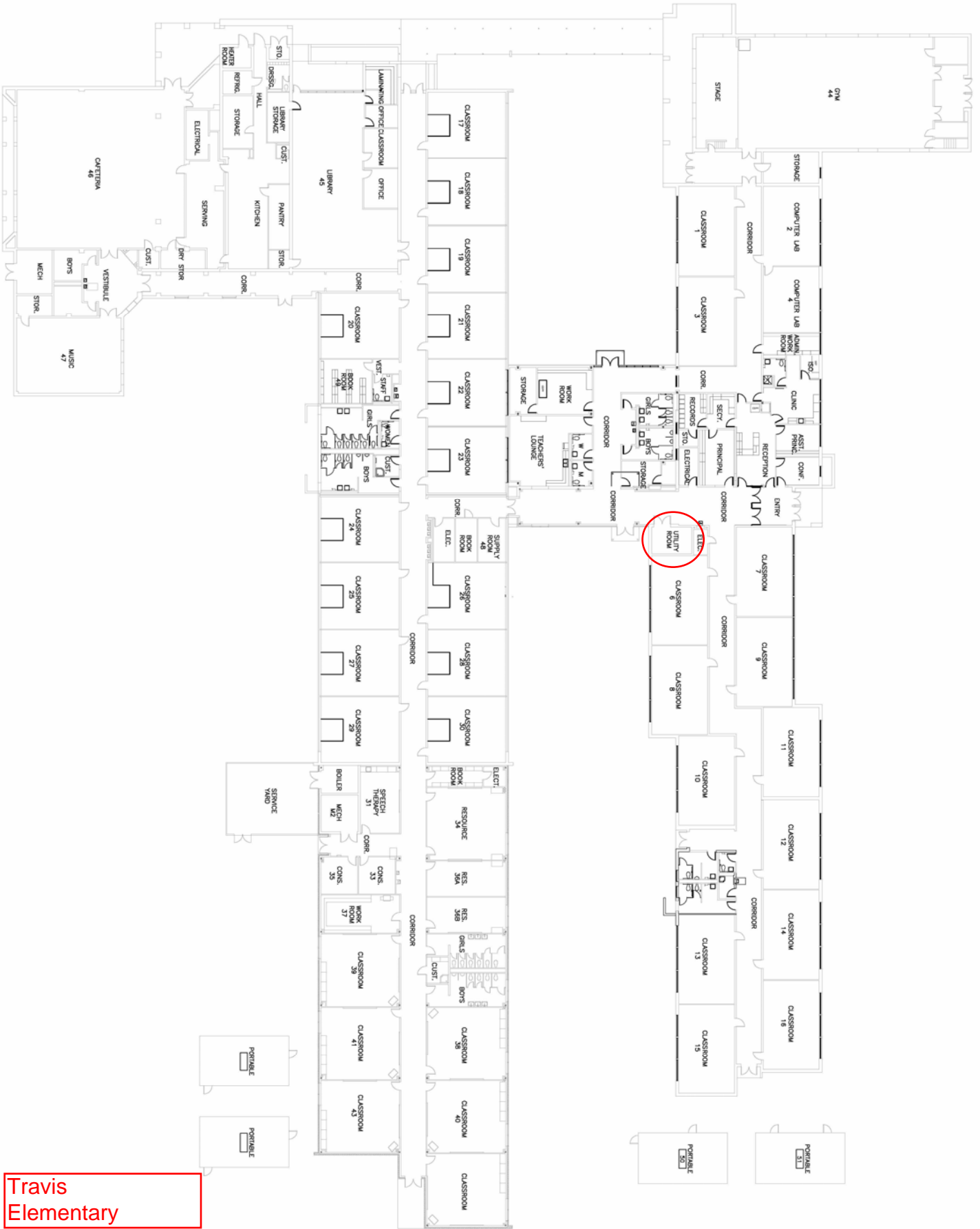

Travis
Elementary

Velasquez Elementary

